

Handling FlexiQuot

1. Take the sample and fill the vial to the maximum to the filling line.

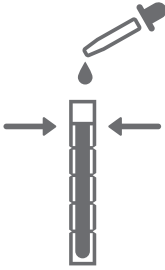

2. Close the tube with the FlexiQuot Cap and make sure that the cap clicks in place.



3. Freeze FlexiQuot in a vertical position according Freezing guidelines.

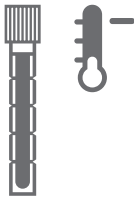

4. After taking FlexiQuot out of the freezer, immediately snap off the Aliquot by using the Snapping tool and Holder. Insert FlexiQuot in the holder and snapping off from the top with the snapping tool.

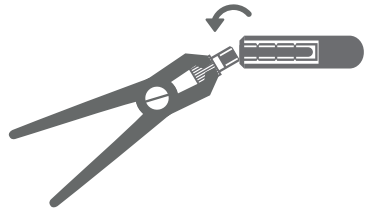

5. After snapping off the desired subsections, the remaining tube is resealed with a new cap and returned to the freezer. Make sure that you never touch the surface of the frozen liquid. (breakage).

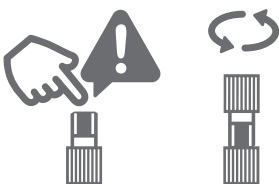

6. The subsection is sealed with another cap and thawed until further analysis.

